



# Robles Park Playground Renovation

8.15.24

Community Play Equipment Update #1

# Summary of Community Playground Equipment Review

---

- An updated playground equipment option for both Robles playgrounds was developed per comments received at community meeting #2 held on 4/4/24 requesting the new proposed play equipment more closely match the existing equipment.
- The following slides show the updated playground equipment for each playground and provides a side-by-side comparison of the existing and the proposed.
- The community is requested to review the updated equipment and provide any further input to the city's Landscape Architect Peter Jensen at [peter.jensen@cityofpalalto.org](mailto:peter.jensen@cityofpalalto.org) or call with questions 650.617.3183
- A possible 3<sup>rd</sup> community meeting could be set if there is no clear community support for the updated options per input received.
- A summary of the input received for this updated playground equipment community review will be provided on the project web site once the community review is completed in October.

# Existing Playground Review

---

## Existing Playground Equipment

# Existing Tot Lot Equipment (Ages 2-5)



## Playground Equipment

- 2 – Tower Landings
- 1 – Double Slide
- 1 – Curved Slide
- 1 – Sway Bridge
- 1 – Rope Climber
- 1 – Tunnel Climber
- 1 – Sand Play Station
- 4 – Spring Riders
- 1 – 2 Bucket Tot Swing

# Existing Playground Equipment (Ages 5 – 12)



## Playground Equipment

- 2 – Tower Landings
- 2 – Spiral Slide
- 1 - Tube Slide
- 1 – Bridge
- 1 – Tunnel Climber
- 1 – Tube Slide
- 1 – Monkey Bars
- 1 – Balance Beam
- 1- Run In Place
- 1 – 2 Strap Seat

# Playground Equipment Update

---

## Tot Lot Playground Updated Design (Ages 2-5)

# Updated Tot Lot Equipment (2-5 Playground)

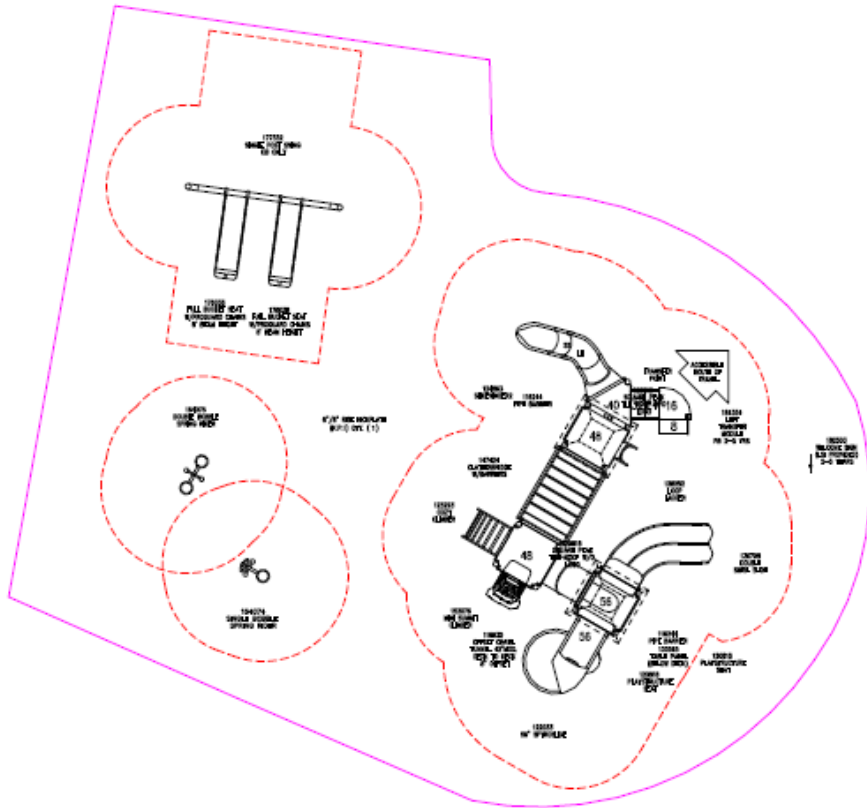

Plan View – Equipment Layout



Proposed Tot Equipment



## Playground Equipment

- 2 - Bucket Tot Swings
- 1 - Single Rider Spring Toys
- 1 – Double Rider Spring Toy
- Climbing Structure
  - 1 Dual Slide
  - 1 Single Slide
  - 1 Spiral Slide
  - Sway Bridge
  - Activity Table
  - Step Climber
  - Ladder Climber
  - Arch Climber
  - Tunnel Climber
  - Double Tower

# Tot Lot Equipment Comparison



Existing Tot Lot Equipment

### Existing Structure

- Dual Slide
- Single Slide
- Tunnel Slide
- Sway Bridge
- Rope Climber
- Tunnel Climber
- Sand Play Station
- Double Tower

### Proposed Structure

- Dual Slide
- Single Slide
- Spiral Slide
- Sway Bridge
- Step Climber
- Ladder Climber
- Arch Climber
- Tunnel Climber
- Activity Table
- Double Tower



Proposed Tot Lot Equipment





# Playground Equipment Update

---

# Playground Equipment Updated Design (Ages 5-12)

# Updated Playground Equipment (5-12 Playground)

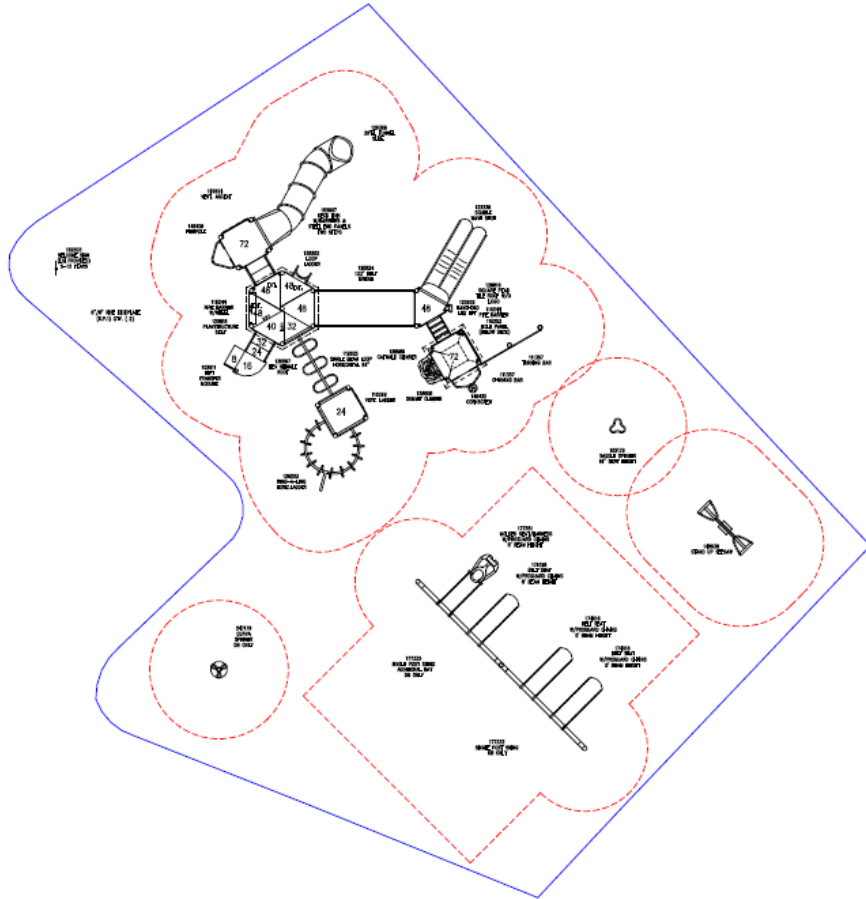

Plan View – Equipment Layout



Proposed Equipment



## Playground Equipment

- 1 – 4 Bay Swing
- 1 – Standing Seesaw
- 1 – Saddle Spinner
- 1 – Standing Spinner

## Climbing Structure

- 1 - Dual Slide
- 1 - Tunnel Slide
- 1 – Parallel Bar
- 1 – Corkscrew Climber
- 1 - Rock Climber
- 1 – Loop Monkey Bars
- 1 – Vertical Ladder
- 1 – Loop Ladder
- 1- Fire Pole
- 1- Belt Bridge

# Playground Equipment Comparison



Existing Playground Equipment

## Playground Equipment

- Spiral Slide
- Tube Slide
- Bridge
- Tunnel Climber
- Tube Slide
- Monkey Bars
- Balance Beam
- Run In Place
- Strap Seat
- Tower Landings



Proposed Equipment

## Proposed Structure

- Dual Slide
- Tunnel Slide
- Parallel Bar
- Sway Bridge
- Corkscrew Climber
- Rock Climber
- Loop Monkey Bars
- Vertical Ladder
- Loop Ladder
- Fire Pole
- Belt Bridge
- Tower Landings



## Project Schedule

# Project Next Steps

---

- On-line community review of the update playground equipment options closes October 11<sup>th</sup>.
- ***If updated equipment design is supported by the community*** - Installation of New Playground to occur in Spring 2025 (4-month Construction Period)
- ***If update equipment design is not support by the community*** – A third community meeting will be held to review further with the installation of new Playground occurring in Summer of 2025

# Project Information

---

- Provide input for the updated playground equipment design to [peter.Jensen@cityofpaloalto.org](mailto:peter.Jensen@cityofpaloalto.org)
- Project web page [www.cityofpaloalto.org/roblespark](http://www.cityofpaloalto.org/roblespark)
- Question call Peter Jensen at 650.617.3183



CITY OF

**PALO ALTO**

---