

NOT YET APPROVED

RESOLUTION NO. _____

RESOLUTION OF THE COUNCIL OF THE CITY OF PALO ALTO ADOPTING AN AMENDMENT TO THE COMPREHENSIVE PLAN LAND USE MAP BY CHANGING THE LAND USE DESIGNATION FOR 725 SAN ANTONIO AVENUE FROM MULTIPLE FAMILY TO NEIGHBORHOOD COMMERCIAL

WHEREAS, the Planning Commission, after duly noticed public hearing on December 6, 2006 recommended that the City Council amend the Land Use Element of the Palo Alto Comprehensive Plan as set forth below; and

WHEREAS, upon consideration of said recommendation after duly noticed public hearing, the Council desires to amend said plan as hereinafter set forth;

The Council of the City of Palo Alto does RESOLVE as follows:

SECTION 1. The City Council finds that the public interest, health, safety and welfare of Palo Alto and the surrounding region require amendment of the Land Use Map of the Palo Alto Comprehensive Plan as set forth in Section 2.

SECTION 2. The City Council hereby amends the Land Use Map of the Palo Alto Comprehensive Plan by changing the designation of the area depicted in Exhibit A from Multiple Family to Neighborhood Commercial. Exhibit A is attached to this resolution and incorporated into it by this reference.

//

//

//

//

//

//

//

NOT YET APPROVED

SECTION 3. The Council finds that the adoption of this resolution will have no significant adverse environmental impact.

INTRODUCED AND PASSED:

AYES:

NOES:

ABSENT:

ABSTENTIONS:

ATTEST:

APPROVED:

City Clerk

Mayor

APPROVED AS TO FORM:

City Manager

Sr. Deputy City Attorney

Director of Planning and
Community Environment

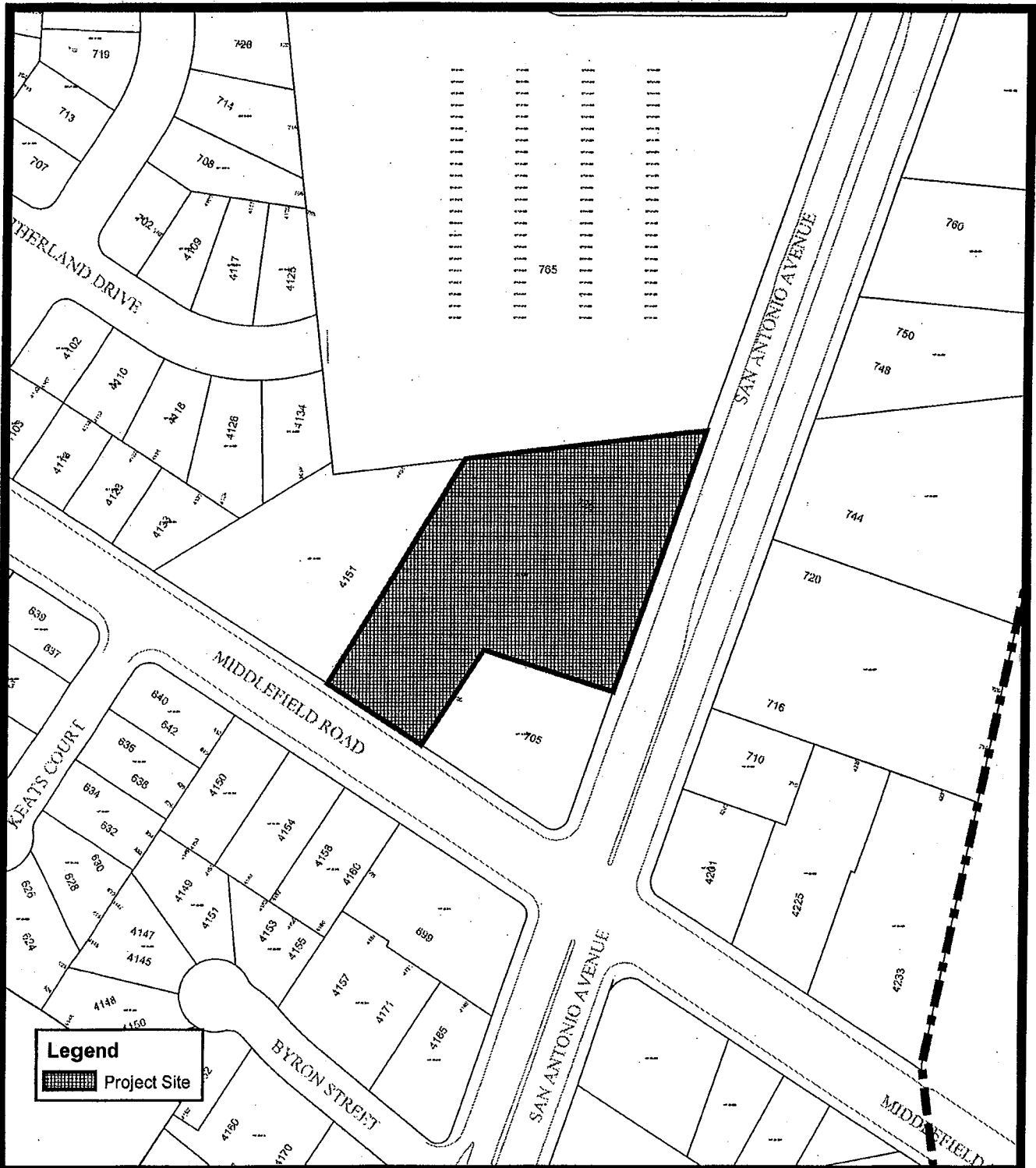

Legend
 Project Site



The City of
Palo Alto

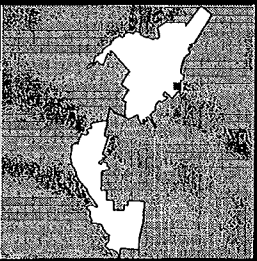

Exhibit A
725 San Antonio Avenue

This map is a product of the
 City of Palo Alto GIS

